

KEY



Catering Table 2200 x 750



Premex Board w915 x h2133



Premex Board w915 x h2133 with feet



Exhibition Stand Area with dimensions

Additional Stands which may be released on demand

Central area subject to 2.9m height restriction

Most likely delegate routes



Upper Level Support Pillars

SEE TABLE
Min Width 990mm !

EXHIBITOR NOTES

1) Stands with same letters can be added together to form a larger exhibition space.

2) where indicated additional space may be included for multiple stands (but may contain upright pillars).

3) Central area is restricted height (2.9m) but this the lowest point (at the beams), areas between beams have a bit more height but you must work on the assumption of no kit higher than 2.9m. These areas are white walled and floored and very well lit.

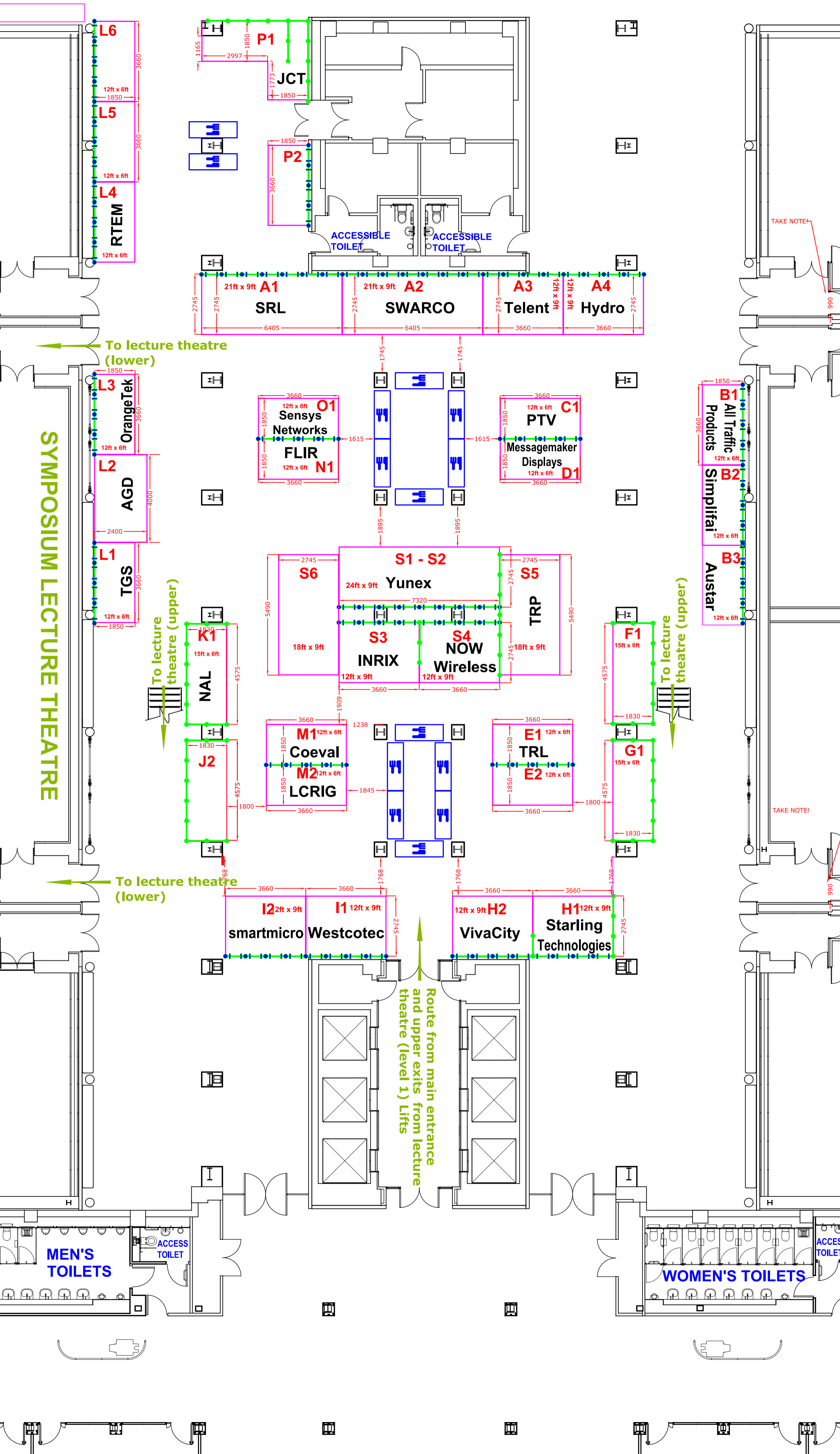

SYMPOSIUM LECTURE THEATRE

To lecture theatre (lower)

To lecture theatre (upper)

To lecture theatre (lower)

Route from main entrance and upper exits from lecture theatre (level 1) Lifts

TAKE NOTE!

TAKE NOTE!

990

990